



**Tulsa Community College
Special Meeting of the Board of Regents
Thursday, September 21, 2017
Metro Campus, Room 212
8:30 a.m.**

AGENDA

1. Call to Order
 - 1.1 Open Meeting Compliance Statement
 - 1.2 Roll Call
2. Old Business
 - 2.1 Recommendation for Approval of the Minutes for the Regular Meeting of the Tulsa Community College Board of Regents held on Monday, August 28, 2017
 - 2.3 Carry Over Items
3. Regular Board Items and Possible Discussion and Action
 - 3.1 Academic Affairs and Student Success Committee Report
Presented by Regent Ballenger
 - 3.1.1 Recommendation for Approval of the Revised Student Immunization Requirement Policy ([Attachment 3.1.1-a](#) and [3.1.1-b](#))
 - 3.2 Personnel Report
Presented by President Goodson
 - 3.2.1 Consent Agenda ([Attachment 3.2.1](#))
 - 3.2.1-a. Recommendation for Approval of Professional Staff Appointments
 - 3.2.1-b. Recommendation for Approval of Renewal of Employee Insurance Benefits
 - 3.3 Facilities Committee Report
Presented by Regent Combs

- 3.3.1 Recommendation for Approval to Enter Into Contract
Negotiations with Crossland Construction Company, Inc.
Remodel of the Student Success Center at Southeast Campus
 - 3.4 Finance, Risk and Audit Committee Report
Presented by Regent Lawhorn
 - 3.4.1 Purchase Item Agreements - Purchases >\$100k
 - 3.4.1-a. Purchase of Signage
 - 3.4.1-b. Purchase of Pavement Repairs
 - 3.4.2 Consent Agenda ([Attachment 3.4.2](#))
 - 3.4.2-a. Purchases between \$50k and \$100k – *No Items*
 - 3.4.2-b. Recommendation for Approval of Renewal of Employee
and Retiree Insurance Benefits and Premiums
 - 3.4.3 Recommendation for Approval of City of Tulsa Tax Abatement
Proposal ([Attachment 3.4.3](#))
 - 3.4.4 Monthly Financial Report – August 2017 ([Attachment 3.4.4](#))
- 4. Presentations by Administration with Possible Discussion
 - 4.1 Trends in Higher Education and Related TCC Experience
Presented by President Goodson
 - 4.2 Using IPEDS data to measure strategic plan KPIs
*Presented by Kevin David, Provost and Associate Vice President of
Institutional Effectiveness, and Jennifer Ivie, Director of Institutional
Research and Assessment*
 - 4.3 Strategic Plan Progress to Date (Review of Selected KPIs)
*Presented by President Goodson and Dr. Kevin David
(E-Team Available for Questions)*
 - 4.4 Multi-Year Budget Forecasting
Presented by Mark McMullen, CFO
 - 4.5 Report from Ad-Hoc Committee on Board Operations and Discussions
Presented by Mackenzie Wilfong, General Counsel
- 5. New Business

 [Pursuant to Title 25 Oklahoma Statutes, Section 311(A)(9), "...any matter not
known about or which could not have been reasonably foreseen prior to the
time of posting." 24 hours prior to meeting]

6. Persons Who Desire to Come Before the Board

[Any person who desires to come before the Board shall notify the board chair or his or her designee in writing or electronically at least twelve (12) hours before the meeting begins. The notification must advise the chair of the nature and subject matter of their remarks and may be delivered to the president's office. All persons shall be limited to a presentation of not more than two minutes.]

7. Executive Session

[Proposed vote to go into executive session Pursuant to Title 25 Oklahoma Statutes, Section 307(B)(4), for confidential communications between a public body and its attorneys concerning pending investigations, claims or actions.]

8. Adjournment

8.1 Next Meeting Date:

The next meeting of the Tulsa Community College Board of Regents will be held on Thursday, October 19, 2017, 3:00 p.m., in Room 1315 at Northeast Campus, 3727 E Apache, Tulsa, Oklahoma.

1. Call to Order

1.1 Open Meeting Compliance Statement

"Statement of Compliance with the Oklahoma Open Meeting Act
(Special meeting scheduled September 21, 2017 at 8:30 a.m.)

This special meeting of the Tulsa Community College Board of Regents has been convened in accordance with the Oklahoma Open Meeting Act.

This meeting was preceded by advance notice of the date, time, and place, filed with the Oklahoma Secretary of State on July 31, 2017.

Notice of this meeting was also given at least twenty-four (24) hours in advance of the meeting by posting notice of the date, time, place, and agenda of the meeting at 9:00 a.m. on September 19, 2017 at the principal office of the Tulsa Community College Board of Regents, located at 6111 E. Skelly Drive, Tulsa, Oklahoma.

1.2 Roll Call

	<u>Present</u>	<u>Absent</u>
Paul H. Cornell, Chair	_____	_____
Robin F. Ballenger, Vice Chair	_____	_____
Samuel Combs, Secretary	_____	_____
Caron A. Lawhorn, Member	_____	_____
Ronald S. Looney, Member	_____	_____
William R. McKamey, Member	_____	_____
Wesley Mitchell, Member	_____	_____

2. Old Business

2.1 Recommendation for Approval of the Minutes for the Regular Meeting of the Tulsa Community College Board of Regents held on Monday, August 28, 2017

MOTION FOR APPROVAL OF THE MINUTES

MOTION:	
SECOND:	

<u>Totals</u>						<u>Motion Carried</u>	
YES		NO		Other		YES	NO
						<input type="checkbox"/>	<input type="checkbox"/>

2.3 Carry Over Items – *No items*

3. Regular Board Items and Possible Discussion and Action

3.1 Academic Affairs and Student Success Committee Report *Presented by Regent Ballenger*

3.1.1 Recommendation for Approval of the Revised Student Immunization Requirements Policy

The Academic Affairs & Student Success Committee recommends approval of the revised Student Immunization Requirements Policy to fulfill Board of Regents requirements as directed in Oklahoma Statute – Title 70, Chapter 50, and Section 3244.

Attachment 3.1.1-a – Proposed Student Immunization Requirements Policy

Attachment 3.1.1-b—Current Policy

MOTION FROM THE ACADEMIC AFFAIRS AND STUDENT SUCCESS COMMITTEE FOR APPROVAL NO SECOND NEEDED

<u>Totals</u>						<u>Motion Carried</u>	
YES		NO		Other		YES	NO
						<input type="checkbox"/>	<input type="checkbox"/>

3.2 Personnel Report *Presented by Regent President Goodson*

3.2.1 Consent Agenda **Attachment 3.2.1 – Personnel Consent Agenda**

3.2.1-a. Appointment of Professional Staff Member

3.2.1-b. Renewal of Employee Insurance Benefits

MOTION FOR APPROVAL OF THE CONSENT AGENDA

MOTION:	
SECOND:	

<u>Totals</u>						<u>Motion Carried</u>	
YES		NO		Other		YES	NO
						<input type="checkbox"/>	<input type="checkbox"/>

3.3 Facilities Committee Report
Presented by Regent Combs

3.3.1 Recommendation for Approval to Enter into Contract Negotiations with Crossland Construction Company, Inc. for the Remodel of the Student Success Center at Southeast Campus

On Monday, July 10, 2017 at 10:00 a.m., requests for qualifications were received from fourteen (14) construction manager firms per request for qualification for the remodel of the Student Success Center at the Southeast Campus.

After careful consideration and evaluation of the qualifications in accordance with Oklahoma Statute Title 61 and 652, it is the recommendation of the Facilities Committee that the pre-construction costs of \$20,610 and the construction manager fee of 3.5% from Crossland Construction Company, Inc., 14149 E. Admiral Place, Tulsa, OK 74116, be accepted.

It is further recommended that College administration be authorized to proceed with contract negotiations with Crossland Construction Company, Inc.

**MOTION FROM THE FACILITIES COMMITTEE FOR APPROVAL
NO SECOND NEEDED**

<u>Totals</u>						<u>Motion Carried</u>	
YES		NO		Other		YES	NO
						<input type="checkbox"/>	<input type="checkbox"/>

3.4 Finance, Risk and Audit Committee Report
Presented by Regent Lawhorn

3.4.1 Purchase Item Agreements (>\$100K)

3.4.1-a. **Purchase of Signage**

Authorization is requested to enter into a contract for the purchase of 10'x30' LED signage for use at the Southeast Campus.

Based on the basis of the best bid submitted meeting specifications, the Finance Committee recommends award of the contract to A-Max Sign Company (Tulsa, OK) in the amount of \$173,030.

**MOTION FROM THE FINANCE, RISK AND AUDIT COMMITTEE
FOR APPROVAL
NO SECOND NEEDED**

<u>Totals</u>						<u>Motion Carried</u>	
YES		NO		Other		YES	NO
						<input type="checkbox"/>	<input type="checkbox"/>

3.4.1.b. **Purchase of Pavement Repairs**

Authorization is requested to enter into a contract for the purchase of pavement repairs at the Metro Campus.

Based on the basis of the best bid submitted meeting specifications, the Finance Committee recommends award of the contract to Ellsworth Construction LLC (Tulsa, OK) in the amount of \$275,304.75 which includes a 5% contingency fee.

**MOTION FROM THE FINANCE, RISK AND AUDIT COMMITTEE
FOR APPROVAL
NO SECOND NEEDED**

<u>Totals</u>						<u>Motion Carried</u>	
YES		NO		Other		YES	NO
						<input type="checkbox"/>	<input type="checkbox"/>

3.4.2 Consent Agenda

Attachment 3.4.2 – Purchasing Consent Agenda

3.4.2-a. Consent Agenda (Between \$50k and \$100k) – *No items*

3.4.2-b. Renewal of Employee and Retiree Insurance Benefits & Premiums

**MOTION FROM THE FINANCE, RISK AND AUDIT COMMITTEE
FOR APPROVAL
NO SECOND NEEDED**

<u>Totals</u>						<u>Motion Carried</u>	
YES		NO		Other		YES	NO
						<input type="checkbox"/>	<input type="checkbox"/>

3.4.3 Recommendation for Approval of City of Tulsa Tax Abatement Proposal

The Finance Committee recommends approval of the City of Tulsa tax abatement proposal by First Place Garage at 410 S. Boston Ave.

**MOTION FROM THE FINANCE, RISK AND AUDIT COMMITTEE
FOR APPROVAL
NO SECOND NEEDED**

<u>Totals</u>						<u>Motion Carried</u>	
YES		NO		Other		YES	NO
						<input type="checkbox"/>	<input type="checkbox"/>

Attachment 3.4.3 – Tax Abatement Proposal

3.4.4 Monthly Financial Report

It is recommended by the Finance, Risk and Audit Committee that the monthly financial report for August 2017 be approved as presented.

**MOTION FROM THE FINANCE, RISK AND AUDIT COMMITTEE
FOR APPROVAL
NO SECOND NEEDED**

<u>Totals</u>						<u>Motion Carried</u>	
YES		NO		Other		YES	NO
						<input type="checkbox"/>	<input type="checkbox"/>

Attachment 3.4.4: Monthly Financial Report – August 2017

4. Presentations by Administration with Possible Discussion

- 4.1 Trends in Higher Education and Related TCC Experience
Presented by President Goodson
- 4.2 Using IPEDS data to measure strategic plan KPIs
Presented by Kevin David, Provost and Associate Vice President of Institutional Effectiveness, and Jennifer Ivie, Director of Institutional Research and Assessment
- 4.3 Strategic Plan Progress to Date (Review of Selected KPIs)
*Presented by President Goodson and Dr. Kevin David
(E-Team Available for Questions)*
- 4.4 Multi-Year Budget Forecasting
Presented by Mark McMullen, CFO
- 4.5 Report from Ad-Hoc Committee on Board Operations and Discussions
Presented by Mackenzie Wilfong, General Counsel

5. New Business

[Pursuant to Title 25 Oklahoma Statutes, Section 311(A)(9), "...any matter not known about or which could not have been reasonably foreseen prior to the time of posting." 24 hours prior to meeting]

6. Persons Who Desire to Come Before the Board

[Any person who desires to come before the Board shall notify the board chair or his or her designee in writing or electronically at least twelve (12) hours before the meeting begins. The notification must advise the chair of the nature and subject matter of their remarks and may be delivered to the president's office. All persons shall be limited to a presentation of not more than two minutes.]

7. Executive Session

[Proposed vote to go into executive session Pursuant to Title 25 Oklahoma Statutes, Section 307(B)(4), for confidential communications between a public body and its attorneys concerning pending investigations, claims or actions.]

MOTION FOR APPROVAL TO RECESS INTO EXECUTIVE SESSION

MOTION:	
SECOND:	

<u>Totals</u>						<u>Motion Carried</u>	
YES		NO		Other		YES	NO
						<input type="checkbox"/>	<input type="checkbox"/>

MOTION FOR APPROVAL TO RECONVENE INTO REGULAR MEETING

MOTION:	
SECOND:	

<u>Totals</u>						<u>Motion Carried</u>	
YES		NO		Other		YES	NO
						<input type="checkbox"/>	<input type="checkbox"/>

8. Adjournment

8.1 Next Meeting Date:

The next meeting of the Tulsa Community College Board of Regents will be held on Thursday, October 19, 2017, 3:00 p.m., in Room 1315 at Northeast Campus, 3727 E Apache, Tulsa, Oklahoma.

STUDENT IMMUNIZATION REQUIREMENTS

REQUIREMENT FOR DOCUMENTATION OF VACCINATIONS AND TO PROVIDE STUDENTS WITH EDUCATIONAL INFORMATION REGARDING HEPATITIS B, MEASLES, MUMPS, AND RUBELLA.

This policy is to fulfill Board of Regents requirement as directed in Oklahoma Statute Title 70 Chapter 50 Article II Section 3244.

In order to enroll as a full-time or part-time student at Tulsa Community College, an individual shall provide verification of vaccinations against hepatitis B, measles, mumps and rubella.

Tulsa Community College shall make available to students of the vaccination requirements and educational materials. Informational materials will include information on hepatitis B, measles, mumps and rubella. Such information shall include the risks and benefits of the vaccinations against hepatitis B, measles, mumps and rubella.

A student may be exempt from the requirement if they provide the following information, or they only enroll in courses delivered via the Internet or distance learning in which the student is not required to attend class on campus.

- A written statement from a licensed physician indicating that a vaccine is medically contraindicated shall exempt a student from the vaccination.
- A student shall be exempt from the vaccination if the student submits a written, signed statement declaring that the administration of the vaccine conflicts with the student's moral or religious tenets or, if the student is a minor, the student's parent or guardian provides a written statement that the administration of the vaccine conflicts with the parent's or guardian's moral or religious tenets.

The Board of Regents, in its discretion, includes exceptions to the requirement for written documentation of vaccinations for each of the following categories of students.

- Students that have been admitted to and attended a public, private, or parochial school in Oklahoma and have complied with the immunization requirements included in Section 1210.191 of Title 70 of Oklahoma Statutes and any applicable State Board of Health Rule;
- Students that have graduated from high school in a state that requires vaccinations for hepatitis B, measles, mumps and rubella;
- Students transferring from an institution within The Oklahoma State System of Higher Education or a private institution of higher learning located within this state and accredited pursuant to Section 4103 of Title 70 of the Oklahoma Statutes;
- Students born before January 1, 1956; and

- Students who are currently on active duty serving in a branch of the United States military.

Tulsa Community College is not required to provide or pay for vaccinations.

3212 Student Vaccination Requirements

In compliance with state law, Tulsa Community College shall provide students with educational information on the hepatitis B and the measles, mumps and rubella (MMR) vaccinations upon enrollment. Such information shall include the risks and benefits of the vaccination. Tulsa Community College shall not be required to provide or pay for vaccinations against hepatitis B, measles, mumps and rubella (MMR). Compliance with Oklahoma law may be achieved by the student (or parent, in the case of a minor) either receiving the vaccinations, affirming that he/she chooses not to be vaccinated due to moral or religious tenets, or affirming their exempt status.

The Board of Regents delegates to the President and CEO of the College or his/her designee representative the authority to exempt the following groups of students:

- The student completes the appropriate TCC form declaring that the administration of the vaccine conflicts with the student's moral or religious tenets, or
- The student is a minor and their parent or guardian completes the appropriate TCC form declaring that the administration of the vaccine conflicts with the parent or guardian's moral or religious tenets, or
- The student provides a written statement from a licensed physician indicating that a vaccine is medically contraindicated, or
- The student graduated in 1996 or later from an Oklahoma high school, or
- The student was born before 1957, or
- The student is transferring from an Oklahoma higher education institution, or
- The student is enrolling only in distance education course(s), or
- The student is non-degree seeking, or
- The student is on active military duty or a member of the reserve.

The Board of Regents delegates to the President and CEO of the College or his/her designated representative the authority to exempt other groups of students not listed here providing such exemptions do not compromise the health and safety of the campus environment.

Legal reference: Oklahoma Statute, Title 70 §3244.

Adopted: April 14, 2004

ADDENDUM FOR PERSONNEL CONSENT ITEMS:

Items listed under Personnel Consent Items will be approved by one motion without discussion. If discussion on an item is desired, the item will be removed from the “Consent Agenda” and considered separately at the request of a Board member.

I. APPOINTMENTS

Lisa Haldeman, Library Director, Northeast Campus
September 6, 2017

Salary: \$50,989

II. RENEWAL OF EMPLOYEE INSURANCE BENEFITS

1. Continuation of Employee Vision Insurance

There will not be an increase in premiums for 2018. This will be year two in our three-year rate guarantee.

	VSP Base Plan	VSP Buy-Up Plan*
Employee Only	\$8.24	\$13.94
Employee + Spouse	\$16.50	\$27.90
Employee + Child(ren)	\$17.64	\$29.84
Family	\$28.20	\$47.70
Estimated Monthly Premium**	\$6,519.16	\$11,027.36
Estimated Annual Premium	\$78,229.92	\$132,328.32

**Buy-Up plan offers richer benefits*

***Estimate based on current employee enrollment*

2. Continuation of Employee Group Life and Accidental Death Insurance

There will not be an increase in premiums for 2018. This will be year two in our three-year rate guarantee.

	Current BCBS - Dearborn National Rates
Group Life Insurance	\$0.15 per \$1000.00 per month*
Basic AD&D	\$0.20 per \$1000.00 per month*
Volume	\$84,888,450.00
Estimated Monthly Premium**	\$14,431.04
Estimated Annual Premium	\$173,172.44

**Three year rate guarantee*

***Estimate based on current enrollment rates*

3. Continuation of Employee Group Life Insurance (2)

There will not be an increase in premiums for 2018. This will be year two in our three-year rate guarantee.

	Recommended BCBS - Dearborn National Rates
Group Life Insurance	\$0.20 per \$1000.00 per month*
Basic AD&D	\$0.00 per \$1000.00 per month
Volume	\$17,720,000.00**
Estimated Monthly Premium**	\$3,544.00
Estimated Annual Premium	\$42,582.00

*Three year rate guarantee

**Volume based on current enrollment

4. Continuation of Employee Voluntary Life & AD&D Insurance

There will not be an increase in premiums for 2018. This will be year two in our three-year rate guarantee.

Rate per \$1000.00	Age Bands	Mutual of Omaha	BCBS – Dearborn National
	<25	\$0.100	\$0.050
	25-29	\$0.100	\$0.060
	30-34	\$0.100	\$0.080
	35-39	\$0.150	\$0.080
	40-44	\$0.150	\$0.100
	45-49	\$0.240	\$0.150
	50-54	\$0.310	\$0.230
	55-59	\$0.460	\$0.440
	60-64	\$0.580	\$0.520
	65-69	\$0.750	\$0.810
	70-74	\$1.000	\$1.280
	75 +	\$1.000	\$1.280
Child(ren)		\$0.980	\$0.160
AD&D			
Employee		\$0.020	\$0.020
Spouse		\$0.020	\$0.020
Child(ren)		\$0.040	\$0.040

5. Continuation of Employee Long-term Disability Insurance

There will not be an increase in premiums for 2018. This will be year two in our three-year rate guarantee.

Rate per \$100.00	\$0.820*
Volume	\$3,575,965**
Estimated Monthly Premium	\$29,322.91
Estimated Annual Premium	\$351,874.96

*Three Year Rate Guarantee

** Based on current enrollment of 755 employees

6. Continuation of Employee Voluntary Cancer and Critical Illness

There will not be an increase in premiums for 2018. This will be year two in our three-year rate guarantee.

ALLSTATE EMPLOYEE RATES	
	Tiers
Employee Only	\$31.74
Employee + Spouse	\$49.24
Employee + Child(ren)	\$44.81
Family	\$62.29

ALLSTATE CRITICAL ILLNESS RATES				
	Non-Tobacco		Tobacco	
Age	EE, EE & CH	EE & SP, Family	EE, EE & CH	EE & SP, Family
18-29	\$1.17	\$1.75	\$1.92	\$2.88
30-39	\$2.73	\$4.10	\$4.62	\$6.93
40-49	\$5.44	\$8.16	\$10.23	\$15.35
50-59	\$10.17	\$15.26	\$18.05	\$27.07
60-63	\$18.09	\$27.14	\$32.39	\$48.59
64+	\$25.40	\$38.10	\$45.97	\$68.96

ADDENDUM FOR PURCHASING CONSENT ITEMS:

Items listed under Purchasing Consent Items will be enacted by one motion with no separate discussion. If discussion on an item is desired, the item will be removed from the “Consent Agenda” and considered separately.

I. PURCHASES BETWEEN \$50K AND \$100K

No items

II. RENEWAL OF EMPLOYEE AND RETIREE INSURANCE BENEFITS & PREMIUMS

1. Renewal of Employee Group Medical Insurance

On December 31, 2017, Tulsa Community College Medical insurance contract with Aetna will end. A renewal is needed to continue offering medical insurance to the College’s full-time employees. The Finance Committee requests authorization to continue the contract with Aetna to provide four medical insurance options January 1, 2018 through December 31, 2018.

Based on NFP Broker negotiations, the College will see an increase in premium costs. The increase will be 12.54% which is comparable to industry standards and potential increases in EGID’s 2018 premiums and below the AHCA predictions for the state of Oklahoma of 20%.

AETNA NEW 2018 RATES*				
	AETNA Plus	AETNA PLAN	AETNA ACO PLUS	AETNA ACO
Employee Only (Employer Paid)	\$589.83	\$600.56	\$542.47	\$535.11
+ Spouse	\$798.84	\$813.24	\$734.54	\$724.57
+ Child	\$299.52	\$304.91	\$275.00	\$271.67
+ Children	\$462.09	\$470.47	\$424.90	\$419.14
+ Spouse + Child	\$1,098.35	\$1,118.13	\$1,009.95	\$996.24
+ Family	\$1,260.93	\$1,283.65	\$1,159.45	\$1,143.72

**2018 EGID rates are located at the end of this report for comparison.*

AETNA EMPLOYEE 2018 RATES with Subsidy*				
	AETNA Plus	AETNA Plan	AETNA ACO Plus	AETNA ACO
Employee Only	\$0.00	\$0.00	\$0.00	\$0.00
+ Spouse	\$660.14	\$672.04	\$607.02	\$598.78
+ Child	\$247.52	\$251.98	\$227.60	\$224.50
+ Children	\$381.88	\$388.76	\$351.14	\$346.38
+ Spouse + Child	\$853.98	\$869.36	\$785.26	\$774.60
+ Family	\$980.38	\$998.04	\$901.50	\$889.26

**Subsidy funded by Savings from 2017 Premiums*

Estimated Monthly Premium	\$633,188.23
Estimated Annual Premium	\$7,598,258.76
Annual Percentage Change	12.54%
Annual Dollar Change	\$846,573.48

2. Renewal of Employee Dental Insurance

On December 31, 2017, Tulsa Community College dental contract with BlueCross BlueShield will expire. A renewal is needed to continue offering dental insurance to the College's full-time employees. The Finance Committee requests authorization to continue the contract with BlueCross and BlueShield – Dearborn National to provide dental insurance January 1, 2018 through December 31, 2018.

Based on NFP Broker negotiations, the College will see an increase in premium costs. The increase will be 19.70%.

	BCBS Base Plan	BCBS Buy-Up Plan
Employee Only (Employer Paid)	\$20.66	\$38.59
+ Spouse	\$41.34	\$77.16
+ Child(ren)	\$54.80	\$100.72
+ Family	\$83.34	\$153.60

2018 EMPLOYEE PAID RATES		
	BCBS Base Plan	BCBS Buy-Up Plan
Employee Only (Employer Paid)	\$0.00	\$0.00
+ Spouse	\$20.68	\$38.57
+ Child(ren)	\$34.14	\$62.13
+ Family	\$62.68	\$115.01
Estimated Monthly Premium	\$56,939.89	
Estimated Annual Premium	\$683,278.68	
Annual Percentage Change	19.70%	
Annual Dollar Change	\$112,448.04	

3. Renewal of Retiree Supplemental Medical Insurance

On December 31, 2017, Tulsa Community College Retiree Supplemental Medical insurance contract with Aetna will end. A renewal is needed to continue offering medical insurance to retirees. The Finance Committee requests authorization to continue the contract with Aetna to provide two medical insurance options January 1, 2018 through December 31, 2018.

Based on NFP Broker negotiations, retirees will see an increase in premium costs.

2018 AETNA Rates*	
	Medicare High Advantage Plan \$388.85
	Medicare Low Advantage Plan \$295.09

**Retirees will continue to receive a \$100-\$105.00 monthly credit to premiums from OTRS*

Medicare High Advantage Plan Percent of Change	20.09%
Medicare Low Advantage Plan Percent of Change	26.32%

First Place Garage

(410 S Boston Ave)

First Place, LLC
First Place Garage
410 S Boston Avenue

01/14/17

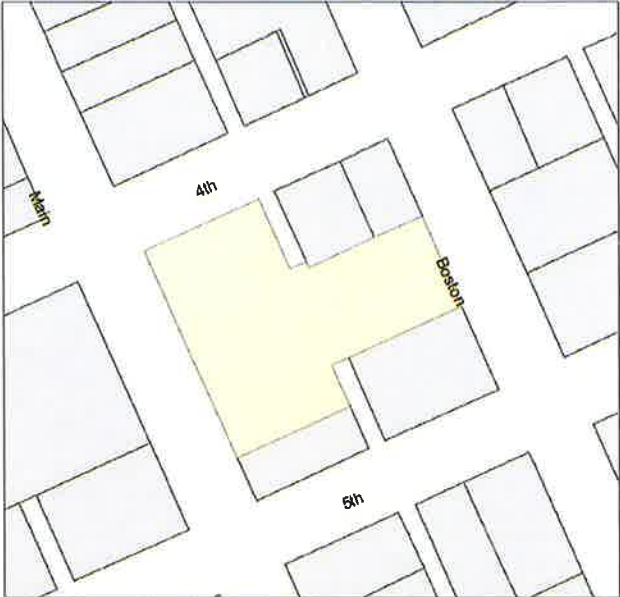

First Place Garage - Parcel

Legal: LT 5 BLK 136 TULSA - DIVISION TOWNSHIP & LTS 2, 4, & 6 BLK 1 FIRST PLACE ADDN RESUB PRT L1-3 & 6-7 B136 ORIGINAL TOWNSHIP TULSA

City of Tulsa - Mayor's Office of Economic Development
April 2017

APPLICANT: FIRST PLACE LLC

PROPERTY LOCATION: 410 S Boston Ave

NARRATIVE DESCRIPTION: THE 410 S. BOSTON AVE. PROJECT PROPOSES DEVELOPMENT OF A DOWNTOWN PARKING GARAGE ON VACANT PORTION OF LOT INTO 519 LEASABLE STALLS ON FLOORS 2-5 PLUS 3,000 SF RESTAURANT/RETAIL SPACE ON THE FIRST FLOOR. PER THE DEVELOPER, THE ESTIMATED CONSTRUCTION VALUE OF THESE IMPROVEMENTS IS \$11,500,000. (TOTAL PROJECT COST IS \$14.8MM.) THIS SITE IS LOCATED IN AN ENTERPRISE ZONE, THE OIL CAPITAL HISTORIC DISTRICT, AND REINVESTMENT AREA. THE BUILDING, CONSISTING OF 167,944 SQUARE FEET, WILL INCLUDE APPROXIMATELY 3,000 SF OF RESTAURANT AND RETAIL SPACE WHICH IS NOT ELIGIBLE.

164,944 SF PARKING GARAGE, 3,000 SF RESTAURANT/RETAIL

TOTAL PROJECT COST: \$14,872,500.

SCENARIO	Existing Values	Estimated Values Upon Completion
Taxable	\$13,289,200	\$24,789,200
Annual Ad Valorem	\$196,248	\$366,074
Abatement: \$366,074 – (\$196,248 + Retail Increase of \$3,033) = \$166,793 @ 6 years = \$1,000,756		

First Place Garage **410 S Boston Ave**

Fair Market Value (FMV)	\$	13,289,200.00	\$	24,789,200.00
Assessment Ratio		11%		11%
Gross Assessment Value	\$	1,461,812.00	\$	2,726,812.00
Tax Rate Millage		134.25		134.25
Estimated Taxes	\$	196,248.26	\$	366,074.51

Ending FMV \$ 24,789,200.00

			Existing Base	Base + Retail	Completion	Year 1	Year 1-6
				Retail Increase	Full Value	Abatement	
Taxable FMV			\$ 13,289,200.00	\$ 13,494,625.62	\$ 24,789,200.00		
			2017	2017	2018		
Organization	%	Millage	Dollars	Dollars	Dollars		
City-County Health Department	2%	2.58	\$ 3,771.47	\$ 3,829.77	\$ 7,035.17	\$ 3,205.40	\$ 19,232.40
City-County Library Commission	4%	5.32	\$ 7,776.84	\$ 7,897.05	\$ 14,506.64	\$ 6,609.58	\$ 39,657.51
Tulsa Technology Center	10%	13.33	\$ 19,485.95	\$ 19,787.17	\$ 36,348.40	\$ 16,561.23	\$ 99,367.41
Tulsa Community College	5%	7.21	\$ 10,539.66	\$ 10,702.59	\$ 19,660.31	\$ 8,957.73	\$ 53,746.36
City (Sinking Fund)	16%	21.2	\$ 30,990.41	\$ 31,469.47	\$ 57,808.41	\$ 26,338.95	\$ 158,033.68
Tulsa County Board of County Commissioners	8%	10.34	\$ 15,115.14	\$ 15,348.79	\$ 28,195.24	\$ 12,846.45	\$ 77,078.69
Tulsa Public Schools (Combined)*	55%	74.27	\$ 108,568.78	\$ 110,247.04	\$ 202,520.33	\$ 92,273.28	\$ 553,639.71
	100%	134.25	\$ 196,248.26	\$ 199,281.88	\$ 366,074.51	\$ 166,792.63	\$ 1,000,755.76

***TPS (Combined)**

	%	Millage	Existing Base	Base + Retail	Completion	Year 1	Year 1-6
School Locally Voted	20.9%	29.07	\$ 42,494.87	\$ 43,151.76	\$ 79,268.42	\$ 36,116.66	\$ 216,699.96
School County Wide Bldg	3.9%	5.15	\$ 7,528.33	\$ 7,644.71	\$ 14,043.08	\$ 6,398.38	\$ 38,390.26
School County Wide ADA	3.0%	4.00	\$ 5,847.25	\$ 5,937.64	\$ 10,907.25	\$ 4,969.61	\$ 29,817.68
School County Wide General	27.1%	36.05	\$ 52,698.32	\$ 53,512.94	\$ 98,301.57	\$ 44,788.63	\$ 268,731.81
	54.9%	74.27	\$ 108,568.78	\$ 110,247.04	\$ 202,520.33	\$ 92,273.28	\$ 553,639.71

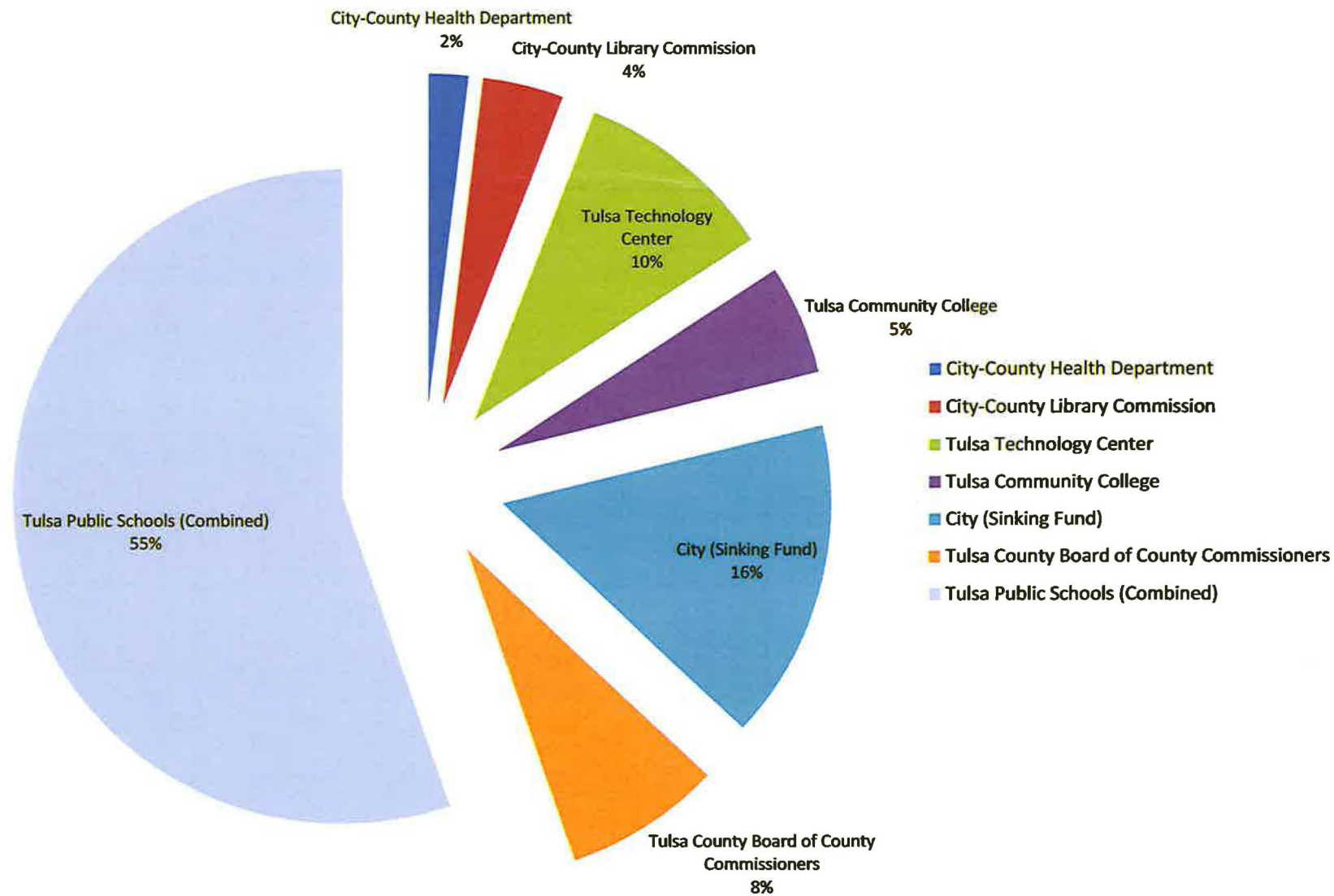





August 23, 2017

Jim Coles
Economic Development Coordinator
City of Tulsa
175 E. 2nd St., Suite 575
Tulsa, OK 74103

RE: Qualification Committee Consideration of Abatement Request by First Place, LLC for 410 South Boston Avenue, Tulsa, OK also referred to as the First Place Garage.

Jim,

The Qualifications Committee (QC) has reviewed the initial application and supporting materials submitted for the project referenced above.

The project is described as:

New construction of 167,944 SF +/- parking garage adjacent to existing tower in downtown Tulsa. First floor structure will have 3,000 SF (approx.) of initial space available for retail use and designed to accommodate future retail development. Remaining floors will be dedicated to 519 +/- paid parking stalls/ Building is expected to be known as First Place Garage.

We believe this project meets the thresholds to be considered further for an abatement under the Local Development Act and related City of Tulsa Policies.

Please continue the appropriate steps under the City of Tulsa Tax Incentive Project Approval Procedures.

Thank you,

Kathy Taylor
Chief of Economic Development
Office of the Mayor

CITY HALL AT ONE TECHNOLOGY CENTER
175 E. 2nd St. • Tulsa, OK 74103
Office 918.596.7411 • Fax 918.596.9010
Email: ktaylor@cityoftulsa.org
www.cityoftulsa.org

TULSA COMMUNITY COLLEGE

FINANCIAL REPORT

MONTH ENDING AUGUST 2017

TULSA COMMUNITY COLLEGE

TABLE OF CONTENTS

SCHEDULE A: Revenue and Expenditures Comparison
Educational & General

SCHEDULE B: Expenditure Summary by
Category

SCHEDULE E: Statement of Revenue,
Expenditures and Campus Store Equity

SCHEDULE A

**TULSA COMMUNITY COLLEGE
STATEMENT OF REVENUE AND EXPENDITURES COMPARISON
FOR THE PERIOD ENDING AUGUST 31, 2017 AND AUGUST 31, 2016**

	AUGUST FY18			AUGUST FY 17				
	Budget	Year to date	Percent of Budget	Budget	Year to date	Percent of Budget	\$ Change	Percent Change
Revenue								
Education & General								
State Appropriations	\$ 28,585,126	\$ 4,856,609	17.0%	\$ 30,408,023	\$ 5,034,742	16.6%	\$ (178,133)	-3.5%
Revolving Fund	2,622,269	981,581	37.4%	2,336,458	724,100	31.0%	257,481	35.6%
Resident Tuition	29,975,268	14,267,823	47.6%	28,523,326	13,615,685	47.7%	652,139	4.8%
Non-Resident Tuition	2,324,228	1,450,525	62.4%	2,467,093	1,383,880	56.1%	66,644	4.8%
Student Fees	6,815,789	2,660,011	39.0%	5,634,788	2,735,744	48.6%	(75,733)	-2.8%
Local Appropriations	39,951,322	5,000,000	12.5%	39,167,963	5,500,000	14.0%	(500,000)	-9.1%
Total	<u>\$ 110,274,002</u>	<u>\$ 29,216,549</u>	<u>26.5%</u>	<u>\$ 108,537,651</u>	<u>\$ 28,994,150</u>	<u>26.7%</u>	<u>\$ 222,399</u>	<u>0.8%</u>
Auxiliary Enterprises								
Campus Store	\$ 6,000,000	\$ 1,241,746	20.7%	\$ 6,500,000	\$ 2,856,316	43.9%	\$ (1,614,570)	-56.5%
Student Activities	2,645,000	995,531	37.6%	2,035,500	1,002,830	49.3%	(7,298)	-0.7%
Other Auxiliary Enterprises	4,565,000	1,460,381	32.0%	8,464,500	1,480,806	17.5%	(20,426)	-1.4%
Total	<u>\$ 13,210,000</u>	<u>\$ 3,697,658</u>	<u>28.0%</u>	<u>\$ 17,000,000</u>	<u>\$ 5,339,952</u>	<u>31.4%</u>	<u>\$ (1,642,294)</u>	<u>-30.8%</u>
Restricted								
Institutional Grants	\$ 3,306,747	\$ 459,715	13.9%	\$ 4,576,625	\$ 796,407	17.4%	\$ (336,692)	-42.3%
State Student Grants	3,250,000	218,520	6.7%	2,277,003	229,093	10.1%	(10,573)	-4.6%
Total	<u>\$ 6,556,747</u>	<u>\$ 678,236</u>	<u>10.3%</u>	<u>\$ 6,853,628</u>	<u>\$ 1,025,500</u>	<u>15.0%</u>	<u>\$ (347,265)</u>	<u>-33.9%</u>
TOTAL REVENUE	<u>\$130,040,749</u>	<u>\$33,592,442</u>	<u>25.8%</u>	<u>\$132,391,279</u>	<u>\$35,359,602</u>	<u>26.7%</u>	<u>\$ (1,767,160)</u>	<u>-5.0%</u>
Expenditures								
Education & General								
Instruction	\$ 47,953,401	\$ 4,805,791	10.0%	\$ 44,743,446	\$ 4,935,226	11.0%	\$ (129,435)	-2.6%
Public Service	491,681	18,078	3.7%	687,735	1,680	0.2%	16,398	976.0%
Academic Support	18,036,190	2,106,640	11.7%	19,888,729	2,103,501	10.6%	3,139	0.1%
Student Services	9,280,778	1,167,421	12.6%	8,359,380	1,557,717	18.6%	(390,296)	-25.1%
Institutional Support	11,652,083	2,376,044	20.4%	13,073,440	2,469,215	18.9%	(93,171)	-3.8%
Operation/ Maintenance of Plant	15,048,069	1,560,763	10.4%	16,128,554	1,833,410	11.4%	(272,647)	-14.9%
Tuition Waivers	3,720,000	1,070,891	28.8%	3,544,500	913,761	25.8%	157,130	17.2%
Scholarships	4,567,500	84,461	1.8%	4,350,000	39,918	0.9%	44,543	111.6%
Total	<u>\$ 110,749,702</u>	<u>\$ 13,190,090</u>	<u>11.9%</u>	<u>\$ 110,775,784</u>	<u>\$ 13,854,428</u>	<u>12.5%</u>	<u>\$ (664,338)</u>	<u>-4.8%</u>
Auxiliary Enterprises								
Campus Store	\$ 6,000,000	\$ 419,083	7.0%	\$ 6,355,000	\$ 393,252	6.2%	\$ 25,831	6.6%
Student Activities	2,645,000	256,682	9.7%	2,385,500	289,381	12.1%	(32,699)	-11.3%
Other Auxiliary Enterprises	4,565,000	325,316	7.1%	8,626,500	322,748	3.7%	2,568	0.8%
Total	<u>\$ 13,210,000</u>	<u>\$ 1,001,081</u>	<u>7.6%</u>	<u>\$ 17,367,000</u>	<u>\$ 1,005,380</u>	<u>5.8%</u>	<u>\$ (4,300)</u>	<u>-0.4%</u>
Restricted								
Institutional Grants	\$ 3,306,747	\$ 462,069	14.0%	\$ 4,576,625	\$ 794,193	17.4%	\$ (332,124)	-41.8%
State Student Grants	3,250,000	11,295	0.3%	2,277,003	13,464	0.6%	(2,169)	-16.1%
Total	<u>\$ 6,556,747</u>	<u>\$ 473,364</u>	<u>7.2%</u>	<u>\$ 6,853,628</u>	<u>\$ 807,657</u>	<u>11.8%</u>	<u>\$ (334,293)</u>	<u>-41.4%</u>
TOTAL EXPENDITURES	<u>\$ 130,516,449</u>	<u>\$ 14,664,534</u>	<u>11.2%</u>	<u>\$ 134,996,412</u>	<u>\$ 15,667,465</u>	<u>11.6%</u>	<u>\$ (1,002,931)</u>	<u>-6.4%</u>

**TULSA COMMUNITY COLLEGE
EXPENDITURE SUMMARY BY CATEGORY
FOR THE PERIOD ENDING AUGUST 31, 2017 AND AUGUST 31, 2016**

	AUGUST FY18			AUGUST FY17				Percent Change
	Budget	Year to date	Percent of Budget	Budget	Year to date	Percent of Budget		
<u>EDUCATION AND GENERAL</u>								
Salaries & Wages								
Faculty	\$ 17,998,337	\$ 1,394,888	7.8%	\$ 17,550,232	\$ 1,460,395	8.3%	\$ (65,507)	-4.5%
Adjunct Faculty	10,000,000	1,301,031	13.0%	11,700,000	1,258,796	10.8%	42,236	3.4%
Professional	9,632,198	1,691,667	17.6%	12,405,669	1,810,136	14.6%	(118,469)	-6.5%
Classified Exempt	4,800,733	476,340	9.9%	4,158,105	609,608	14.7%	(133,268)	-21.9%
Classified Hourly	15,374,028	1,596,414	10.4%	13,316,054	1,638,752	12.3%	(42,338)	-2.6%
TOTAL	\$ 57,805,296	\$ 6,460,341	11.2%	\$ 59,130,060	\$ 6,777,686	11.5%	\$ (317,346)	-4.7%
Staff Benefits	\$ 21,015,421	\$ 2,685,707	12.8%	\$ 21,569,019	\$ 2,761,979	12.8%	(76,272)	-2.8%
Professional Services	2,399,350	202,742	8.4%	2,835,900	194,714	6.9%	8,028	4.1%
Operating Services	17,552,735	2,402,067	13.7%	14,527,578	2,687,863	18.5%	(285,795)	-10.6%
Travel	443,700	50,161	11.3%	452,420	30,292	6.7%	19,869	65.6%
Utilities	1,745,700	196,062	11.2%	1,908,500	228,953	12.0%	(32,891)	-14.4%
Tuition Waivers	3,720,000	1,070,891	28.8%	3,544,500	913,761	25.8%	157,130	17.2%
Scholarships	4,567,500	84,461	1.8%	4,350,000	39,918	0.9%	44,543	111.6%
Furniture & Equipment	1,500,000	37,658	2.5%	2,457,807	219,263	8.9%	(181,605)	-82.8%
TOTAL	\$ 110,749,702	\$ 13,190,090	11.9%	\$ 110,775,784	\$ 13,854,428	12.5%	\$ (664,338)	-4.8%

TULSA COMMUNITY COLLEGE
EXPENDITURE SUMMARY BY CATEGORY
FOR THE PERIOD ENDING AUGUST 31, 2017 AND AUGUST 31, 2016

	AUGUST FY18			AUGUST FY17				
	Budget	Year to date	Percent of Budget	Budget	Year to date	Percent of Budget	\$ Change	Percent Change
<u>CAMPUS STORE</u>								
Salaries & Wages								
Professional & Classified Exempt	\$ 232,800	\$ 44,744	19.2%	\$ 258,122	\$ 45,895	17.8%	\$ (1,151)	-2.5%
Classified Hourly	388,000	67,216	17.3%	447,291	73,183	16.4%	(5,968)	-8.2%
Total Salaries & Wages	\$ 620,800	\$ 111,960	18.0%	\$ 705,413	\$ 119,079	16.9%	\$ (7,119)	-6.0%
Staff Benefits	\$ 349,200	\$ 36,970	10.6%	\$ 224,587	\$ 34,209	15.2%	\$ 2,761	8.1%
Professional Services		-	0.0%	-	-	0.0%	-	0.0%
Operating Services	545,211	660	0.1%	590,000	-	0.0%	660	100.0%
Travel	15,000	32	0.2%	5,000	108	2.2%	(76)	-70.0%
Utilities	85,000	2,746	3.2%	85,000	3,180	3.7%	(434)	-13.6%
Items for Resale - Campus Store	4,384,789	265,425	6.1%	4,745,000	236,677	5.0%	28,748	12.1%
Furniture & Equipment		1,290	0.0%	-	-	0.0%	1,290	100.0%
TOTAL	\$ 6,000,000	\$ 419,083	7.0%	\$ 6,355,000	\$ 393,252	6.2%	\$ 25,831	6.6%
<u>STUDENT ACTIVITIES</u>								
Salaries & Wages								
Professional	\$ 598,300	\$ 67,104	11.2%	\$ 613,385	\$ 88,276	14.4%	\$ (21,172)	-24.0%
Classified Hourly	636,900	66,629	10.5%	686,230	61,174	8.9%	5,455	8.9%
Total Salaries & Wages	\$ 1,235,200	\$ 133,733	10.8%	\$ 1,299,615	\$ 149,450	11.5%	\$ (15,717)	-10.5%
Staff Benefits	\$ 694,800	\$ 52,369	7.5%	\$ 520,385	\$ 57,074	11.0%	\$ (4,704)	-8.2%
Professional Services	59,319	14,215	24.0%	46,181	1,189	2.6%	13,026	1095.5%
Operating Services	474,387	49,818	10.5%	369,319	78,922	21.4%	(29,104)	-36.9%
Travel	40,000	2,247	5.6%	40,000	2,747	6.9%	(500)	-18.2%
Furniture & Equipment	12,845	-	0.0%	10,000	-	0.0%	-	0.0%
Items for Resale	128,449	4,300	3.3%	100,000	-	0.0%	4,300	100.0%
TOTAL	\$ 2,645,000	\$ 256,682	9.7%	\$ 2,385,500	\$ 289,381	12.1%	\$ (32,699)	-11.3%
<u>OTHER AUXILIARY ENTERPRISES</u>								
Salaries & Wages								
Professional	\$ 107,726	\$ 9,286	8.6%	\$ 120,789	\$ 22,619	18.7%	\$ (13,333)	-58.9%
Adjunct Faculty	167,786	27,657	16.5%	188,132	22,638	12.0%	5,019	22.2%
Classified Hourly	271,752	2,766	1.0%	304,705	-	0.0%	2,766	100.0%
Total Salaries & Wages	\$ 547,264	\$ 39,709	7.3%	\$ 613,626	\$ 45,257	7.4%	\$ (5,548)	-12.3%
Staff Benefits	\$ 87,735	\$ 9,910	11.3%	\$ 98,374	\$ 11,962	12.2%	\$ (2,052)	-17.2%
Professional Services	115,010	47,025	40.9%	447,082	29,912	6.7%	17,113	57.2%
Operating Services	1,238,273	74,066	6.0%	4,813,558	144,101	3.0%	(70,035)	-48.6%
Travel	-	10,153	0.0%	-	4,375	0.0%	5,777	132.0%
Utilities	750,000	77,614	10.3%	750,000	85,857	11.4%	(8,243)	-9.6%
Scholarship & Refunds	-	1,191	0.0%	-	-	0.0%	1,191	100.0%
Bond Principal and Expense	1,800,000	65,648	3.6%	1,800,000	-	0.0%	65,648	100.0%
Furniture & Equipment	25,725	-	0.0%	100,000	970	1.0%	(970)	-100.0%
Items for Resale	993	-	0.0%	3,860	313	8.1%	(313)	-100.0%
TOTAL	\$ 4,565,000	\$ 325,316	7.1%	\$ 8,626,500	\$ 322,748	3.7%	\$ 2,568	0.8%

TULSA COMMUNITY COLLEGE-CAMPUS STORE
STATEMENT OF REVENUE, EXPENDITURES AND CAMPUS STORE EQUITY
FOR THE TWO MONTHS ENDING AUGUST 31, 2017 AND AUGUST 31, 2016

	AUGUST FY18		AUGUST FY17			
	Current Year	Percent of Sales	Prior Year	Percent of Sales	Increase/ (Decrease)	Percent Change
Income From Sales						
Sales (From 07-01-17 To 08-31-17)						
Textbooks, Supplies, and Soft Goods	\$ 1,238,470		\$ 2,851,080		\$ (1,612,610)	-56.6%
Total Sales	1,238,470	100.0%	2,851,080	100.0%	(1,612,610)	-56.6%
Less: Cost of Goods Sold	714,706	57.7%	2,138,408	75.0%	(1,423,702)	-66.6%
Gross Income/(Loss) on Sales	523,763	42.3%	712,672	25.0%	(188,909)	-26.5%
Operating Expenses						
Selling Expenses	111,960	9.0%	119,079	4.2%	(7,119)	-6.0%
Total Selling Expense	111,960	9.0%	119,079	4.2%	(7,119)	-6.0%
Administrative Expenses						
Personnel Benefits	36,970	3.0%	34,209	1.2%	2,761	8.1%
Travel	32	0.0%	108	0.0%	(76)	-70.0%
Operating Expense	4,696	0.4%	3,180	0.1%	1,516	47.7%
Total Administrative Expense	41,698	3.4%	37,496	1.3%	4,201	11.2%
Total Selling and Administrative Expense	153,658	12.4%	156,575	5.5%	(2,917)	-1.9%
Net Selling Income/(Loss)	370,106	29.9%	556,097	19.5%	(185,991)	-33.4%
Other Income/(Loss)						
Commission Income	-	0.0%	8,260	0.3%	(8,260)	-100.0%
Other Expense	-	0.0%	-	0.0%	-	0.0%
	-	0.0%	8,260	0.3%	(8,260)	-100.0%
Net Income/(Loss)	\$ 370,106	29.9%	\$ 564,357	19.8%	(194,251)	-34.4%
Equity Balance July 1, 2017	6,807,051		6,606,607		200,444	3.0%
Equity Balance August 31, 2017	\$ 7,177,157		\$ 7,170,964		6,193	0.1%
	Current Year	Prior Year	Increase/ (Decrease)	Percent Change		
Inventory July 1, 2017	\$ 1,419,157	\$ 1,751,939	\$ (332,782)	-19.0%		
Purchases						
Textbooks, Supplies, and Soft Goods	1,192,645	1,640,789	(448,144)	-27.3%		
Total Purchases	1,192,645	1,640,789	(448,144)	-27.3%		
Freight-In	5,182	-	5,182			
	1,197,827	1,640,789	(442,962)	-27.0%		
Cost of Goods Available for Sale	2,616,984	3,392,728	(775,744)	-22.9%		
Deduct Inventory August 31, 2017	1,902,278	1,254,320	647,958	51.7%		
Cost of Goods Sold	\$ 714,706	\$ 2,138,408	(1,423,702)	-66.6%		

TULSA COMMUNITY COLLEGE
STATEMENT OF REVENUE AND EXPENDITURES COMPARISON
FOR THE PERIOD ENDING AUGUST 31, 2017

	YTD						TOTAL YEAR	
	Actual	Budget	Prior Year	Better/(Worse)		Budget	Prior Year	
				Budget	Prior Year			
Revenue				Actual - Budget	Actual - Prior Year			
Education & General								
State Appropriations	\$ 4,856,609	\$ 5,025,634	\$ 5,034,742	\$ (169,025)	\$ (178,133)	\$ 28,585,126	\$ 30,949,600	
Revolving Fund	981,581	543,050	724,100	438,531	257,481	2,622,269	4,116,314	
Resident Tuition	14,267,823	13,918,101	13,615,685	349,722	652,139	29,975,268	28,563,759	
Non-Resident Tuition	1,450,525	1,137,186	1,383,880	313,339	66,644	2,324,228	2,642,736	
Student Fees	2,660,011	3,109,690	2,735,744	(449,679)	(75,733)	6,815,789	5,793,173	
Local Appropriations	5,000,000	5,949,945	5,500,000	(949,945)	(500,000)	39,951,322	34,500,000	
Total	\$ 29,216,549	\$ 29,683,606	\$ 28,994,150	\$ (467,057)	\$ 222,399	\$ 110,274,002	\$ 106,565,583	
Auxiliary Enterprises								
Campus Store	\$ 1,241,746	\$ 2,512,722	\$ 2,856,316	\$ (1,270,976)	\$ (1,614,570)	\$ 6,000,000	\$ 6,883,248	
Student Activities	995,531	\$ 1,177,755	1,002,830	(182,224)	(7,298)	2,645,000	2,201,626	
Other Auxiliary Enterprises	1,460,381	\$ 1,721,867	1,480,806	(261,487)	(20,426)	4,565,000	4,243,570	
Total	\$ 3,697,658	\$ 5,412,345	\$ 5,339,952	\$ (1,714,687)	\$ (1,642,294)	\$ 13,210,000	\$ 13,328,443	
Restricted								
Institutional Grants	\$ 459,715	\$ 471,802	\$ 796,407	\$ (12,087)	\$ (336,692)	\$ 3,306,747	\$ 5,435,996	
State Student Grants	218,520	\$ 122,286	229,093	96,235	(10,573)	3,250,000	3,731,913	
Total	\$ 678,236	\$ 594,088	\$ 1,025,500	\$ 84,148	\$ (347,265)	\$ 6,556,747	\$ 9,167,909	
TOTAL REVENUE	\$ 33,592,442	\$ 35,690,039	\$ 35,359,602	\$ (2,097,597)	\$ (1,767,160)	\$ 130,040,749	\$129,061,935	

TULSA COMMUNITY COLLEGE
STATEMENT OF REVENUE AND EXPENDITURES COMPARISON
FOR THE PERIOD ENDING AUGUST 31, 2017

	YTD						TOTAL YEAR	
	Actual	Budget	Prior Year	Better/(Worse)		Budget	Prior Year	
				Budget	Prior Year			
Expenditures				Budget - Actual	Prior Year - Actual			
Education & General								
Instruction	\$ 4,805,791	\$ 5,410,759	\$ 4,935,226	\$ 604,967	\$ 129,435	\$ 47,953,401	\$ 41,777,426	
Public Service	18,078	39,406	1,680	21,327	(16,398)	491,681	233,757	
Academic Support	2,106,640	2,725,370	2,103,501	618,731	(3,139)	18,036,190	14,746,160	
Student Services	1,167,421	1,419,779	1,557,717	252,358	390,296	9,280,778	9,667,862	
Institutional Support	2,376,044	2,102,539	2,469,215	(273,505)	93,171	11,652,083	13,455,663	
Operation/ Maintenance of Plant	1,560,763	1,794,007	1,833,410	233,244	272,647	15,048,069	13,895,004	
Tuition Waivers	1,070,891	892,943	913,761	(177,948)	(157,130)	3,720,000	4,246,701	
Scholarships	84,461	67,320	39,918	(17,141)	(44,543)	4,567,500	4,651,694	
Total	\$ 13,190,090	\$ 14,452,123	\$ 13,854,428	\$ 1,262,033	\$ 664,338	\$ 110,749,702	\$ 102,674,267	
Auxiliary Enterprises								
Campus Store	\$ 419,083	\$ 943,858	\$ 393,252	\$ 524,775	\$ (25,831)	\$ 6,000,000	\$ 6,986,034	
Student Activities	256,682	352,495	289,381	95,813	32,699	2,645,000	2,254,467	
Other Auxiliary Enterprises	325,316	445,327	322,748	120,011	(2,568)	4,565,000	4,209,307	
Total	\$ 1,001,081	\$ 1,741,680	\$ 1,005,380	\$ 740,599	\$ 4,300	\$ 13,210,000	\$ 13,449,808	
Restricted								
Institutional Grants	\$ 462,069	\$ 440,828	\$ 794,193	\$ (21,241)	\$ 332,124	\$ 3,306,747	\$ 5,429,946	
State Student Grants	11,295	21,015	13,464	9,720	2,169	3,250,000	3,717,581	
Total	\$ 473,364	\$ 461,843	\$ 807,657	\$ (11,521)	\$ 334,293	\$ 6,556,747	\$ 9,147,527	
TOTAL EXPENDITURES	\$ 14,664,534	\$ 16,655,645	\$ 15,667,465	\$ 1,991,111	\$ 1,002,931	\$ 130,516,449	\$ 125,271,602	

TULSA COMMUNITY COLLEGE
EXPENDITURE SUMMARY BY CATEGORY
FOR THE PERIOD ENDING AUGUST 31, 2017

YTD						TOTAL YEAR							
Actual	Budget	Prior Year	Better/(Worse)		Budget	Prior Year	Budget	Prior Year					
			Budget - Actual	Prior Year - Actual									
\$	1,394,888	\$	1,483,484	\$	1,460,395	\$	88,596	\$	65,507	\$	17,998,337	\$	17,296,011
	1,301,031		1,265,682		1,258,796		(35,349)		(42,236)		10,000,000		9,897,436
	1,691,667		1,595,932		1,810,136		(95,735)		118,469		9,632,198		10,680,926
	476,340		786,047		609,608		309,707		133,268		4,800,733		3,500,209
	1,596,414		1,855,405		1,638,752		258,991		42,338		15,374,028		13,743,358
\$	6,460,341	\$	6,986,550	\$	6,777,686	\$	526,209	\$	317,346	\$	57,805,296	\$	55,117,940
\$	2,685,707	\$	2,826,409	\$	2,761,979	\$	140,703	\$	76,272	\$	21,015,421	\$	20,072,919
	202,742		241,948		194,714		39,206		(8,028)		2,399,350		2,025,274
	2,402,067		3,027,857		2,687,863		625,789		285,795		17,552,735		12,901,196
	50,161		39,242		30,292		(10,920)		(19,869)		443,700		473,228
	196,062		198,624		228,953		2,562		32,891		1,745,700		1,656,355
	1,070,891		875,727		913,761		(195,164)		(157,130)		3,720,000		4,246,701
	84,461		66,022		39,918		(18,439)		(44,543)		4,567,500		4,651,694
	37,658		189,743		219,263		152,085		181,605		1,500,000		1,528,960
\$	13,190,090	\$	14,452,123	\$	13,854,428	\$	1,262,033	\$	664,338	\$	110,749,702	\$	102,674,267

TULSA COMMUNITY COLLEGE
EXPENDITURE SUMMARY BY CATEGORY
FOR THE PERIOD ENDING AUGUST 31, 2017

	YTD						TOTAL YEAR	
	Actual	Budget	Prior Year	Better/(Worse)		Budget	Prior Year	
				Budget - Actual	Prior Year - Actual			
<u>CAMPUS STORE</u>								
Salaries & Wages								
Professional & Classified Exempt	\$ 44,744	\$ 37,425	\$ 45,895	\$ (7,320)	\$ 1,151	\$ 232,800	\$ 303,075	
Classified Hourly	67,216	55,839	73,183	(11,376)	5,968	388,000	581,194	
Total Salaries & Wages	\$ 111,960	\$ 93,264	\$ 119,079	\$ (18,696)	\$ 7,119	\$ 620,800	\$ 884,268	
Staff Benefits	\$ 36,970	\$ 50,669	\$ 34,209	\$ 13,699	\$ (2,761)	\$ 349,200	\$ 258,127	
Professional Services	-	-	-	-	0	-	-	
Operating Services	660	32,296	-	31,636	(660)	545,211	42,289	
Travel	32	716	108	684	76	15,000	1,139	
Utilities	2,746	10,324	3,180	7,578	434	85,000	22,980	
Items for Resale - Campus Store	265,425	756,588	236,677	491,163	(28,748)	4,384,789	5,777,231	
Furniture & Equipment	1,290	-	-	(1,289.97)	(1,289.97)	-	-	
TOTAL	\$ 419,083	\$ 943,858	\$ 393,252	\$ 524,775	\$ (25,831)	\$ 6,000,000	\$ 6,986,034	

TULSA COMMUNITY COLLEGE
EXPENDITURE SUMMARY BY CATEGORY
FOR THE PERIOD ENDING AUGUST 31, 2017

	YTD						TOTAL YEAR	
	Actual	Budget	Prior Year	Better/(Worse)		Budget	Prior Year	
				Budget - Actual	Prior Year - Actual			
<u>STUDENT ACTIVITIES</u>								
Salaries & Wages								
Professional	\$ 67,104	\$ 100,249	\$ 88,276	\$ 33,145	\$ 21,172	\$ 598,300	\$ 511,820	
Classified Hourly	66,629	75,646	61,174	9,016	(5,455)	636,900	605,292	
Total Salaries & Wages	\$ 133,733	\$ 175,895	\$ 149,450	\$ 42,162	\$ 15,717	\$ 1,235,200	\$ 1,117,112	
Staff Benefits	\$ 52,369	\$ 97,458	\$ 57,074	\$ 45,089	\$ 4,704	\$ 694,800	\$ 417,993	
Professional Services	14,215	3,348	1,189	(10,868)	(13,026)	59,319	52,054	
Operating Services	49,818	61,005	78,922	11,187	29,104	474,387	494,409	
Travel	2,247	1,729	2,747	(518)	500	40,000	37,356	
Furniture & Equipment	-	1,072	-	1,072	0	12,845	69,099	
Items for Resale	4,300	11,989	-	7,689	(4,300)	128,449	66,443	
TOTAL	\$ 256,682	\$ 352,495	\$ 289,381	\$ 95,813	\$ 32,699	\$ 2,645,000	\$ 2,254,467	

TULSA COMMUNITY COLLEGE
EXPENDITURE SUMMARY BY CATEGORY
FOR THE PERIOD ENDING AUGUST 31, 2017

	YTD						TOTAL YEAR	
	Actual	Budget	Prior Year	Better/(Worse)		Budget	Prior Year	
				Budget - Actual	Prior Year - Actual			
<u>OTHER AUXILIARY ENTERPRISES</u>								
Salaries & Wages								
Professional	\$ 9,286	\$ 23,128	\$ 22,619	\$ 13,843	\$ 13,333	\$ 107,726	\$ 115,713	
Adjunct Faculty	27,657	32,019	22,638	4,361	(5,019)	167,786	181,045	
Classified Hourly	2,766	8,848	-	6,081	(2,766)	271,752	319,659	
Total Salaries & Wages	\$ 39,709	\$ 63,995	\$ 45,257	\$ 24,285	\$ 5,548	\$ 547,265	\$ 616,417	
Staff Benefits	\$ 9,910	\$ 12,845	\$ 11,962	\$ 2,935	\$ 2,052	\$ 87,735	\$ 100,749	
Professional Services	47,025	17,605	29,912	(29,420)	(17,113)	115,010	362,588	
Operating Services	74,066	242,194	144,101	168,129	70,035	1,238,272	1,304,543	
Travel	10,153	-	4,375	(10,153)	(5,777)	-	32,877	
Utilities	77,614	106,911	85,857	29,297	8,243	750,000	653,382	
Scholarship & Refunds	1,191	-	-	(1,191)	(1,191)	-	4,340	
Bond Principal and Expense	65,648	-	-	(65,648)	(65,648)	1,800,000	1,120,222	
Furniture & Equipment	-	1,476	970	1,476	970	25,725	12,512	
Items for Resale	-	300	313	300	313	993	1,677	
TOTAL	\$ 325,316	\$ 445,327	\$ 322,748	\$ 120,011	\$ (2,568)	\$ 4,565,000	\$ 4,209,307	